

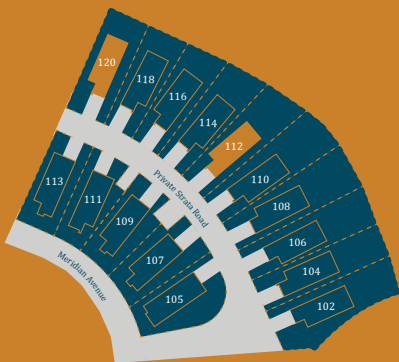

**4 BED | 3.5 BATH
+ FAMILY ROOM**
2,419 SQ. FT.

UNITS

112 120



Westhills

LOWER

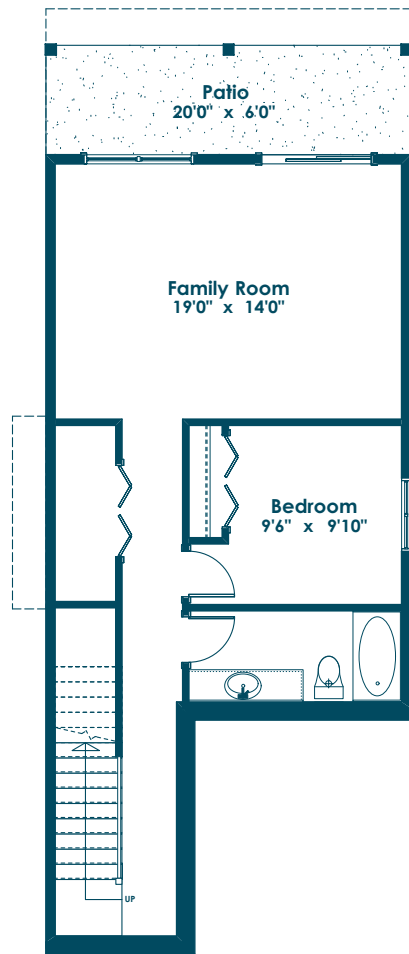

708 SQ. FT.

MAIN

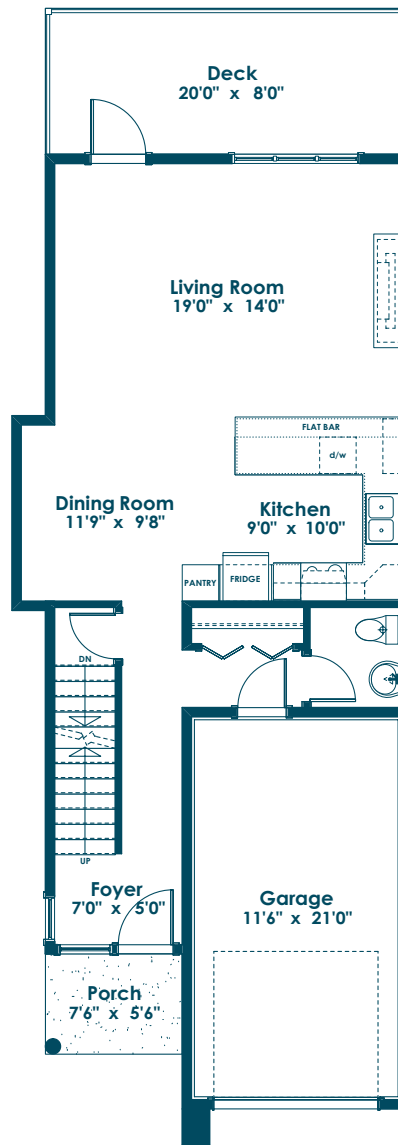

727 SQ. FT.

UPPER

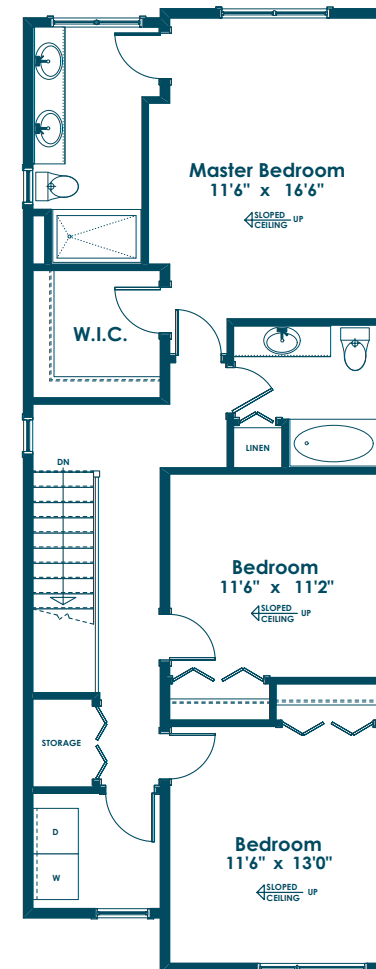

984 SQ. FT.

westhillsbc.com

The developer reserves the right to make modifications contained herein. Sizes, specifications, layouts, plans, features, finishes and availability may change without notice. E.&O.E.